



SERVICE BULLETIN

BULLETIN # 04-03
DATE: 9/5/2003
SUBJECT: 48 CONVERTIBLE
Fwd Headliner Accent Part – Reinforce Fastening Procedure
HULL #s: 09147, 31, 32, 33, 34, & 35

It has come to our attention that the headliner accent panel in the forward stateroom is not sufficiently secured. Over time, from the movement and vibration of boat operation it could come loose and fall.

Please perform the following repair to correct this potential problem:

1. Pull down the 3 cabin lights – you do not need to unhook them.
2. Drill a 1/2" hole through the plywood block above light hole and through headliner – each light hole area. *Note: Watch you don't drill wires for lights.*
3. Insert the toggle bolt through hole. Follow installation instructions
4. Use the 1/2" -20 x 1 1/2" pan head bolt to secure down tightly.
5. Reinstall cabin lights.

48 CONVERTIBLE

- fwd Headliner Accent Part – Reinforce fastening Procedure

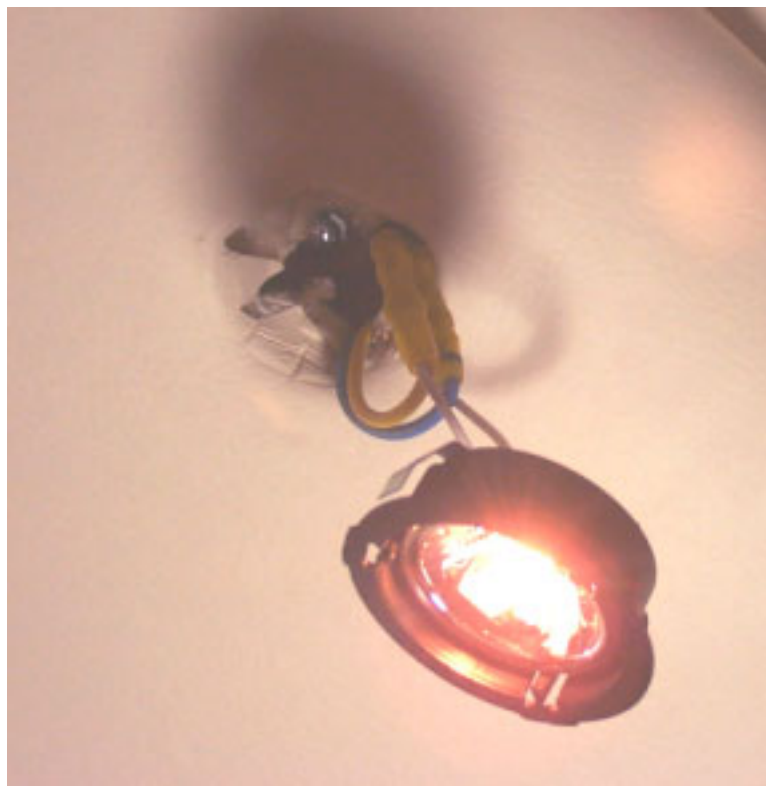

48 CONVERTIBLE

- fwd Headliner Accent Part – Reinforce fastening Procedure

Step - 2

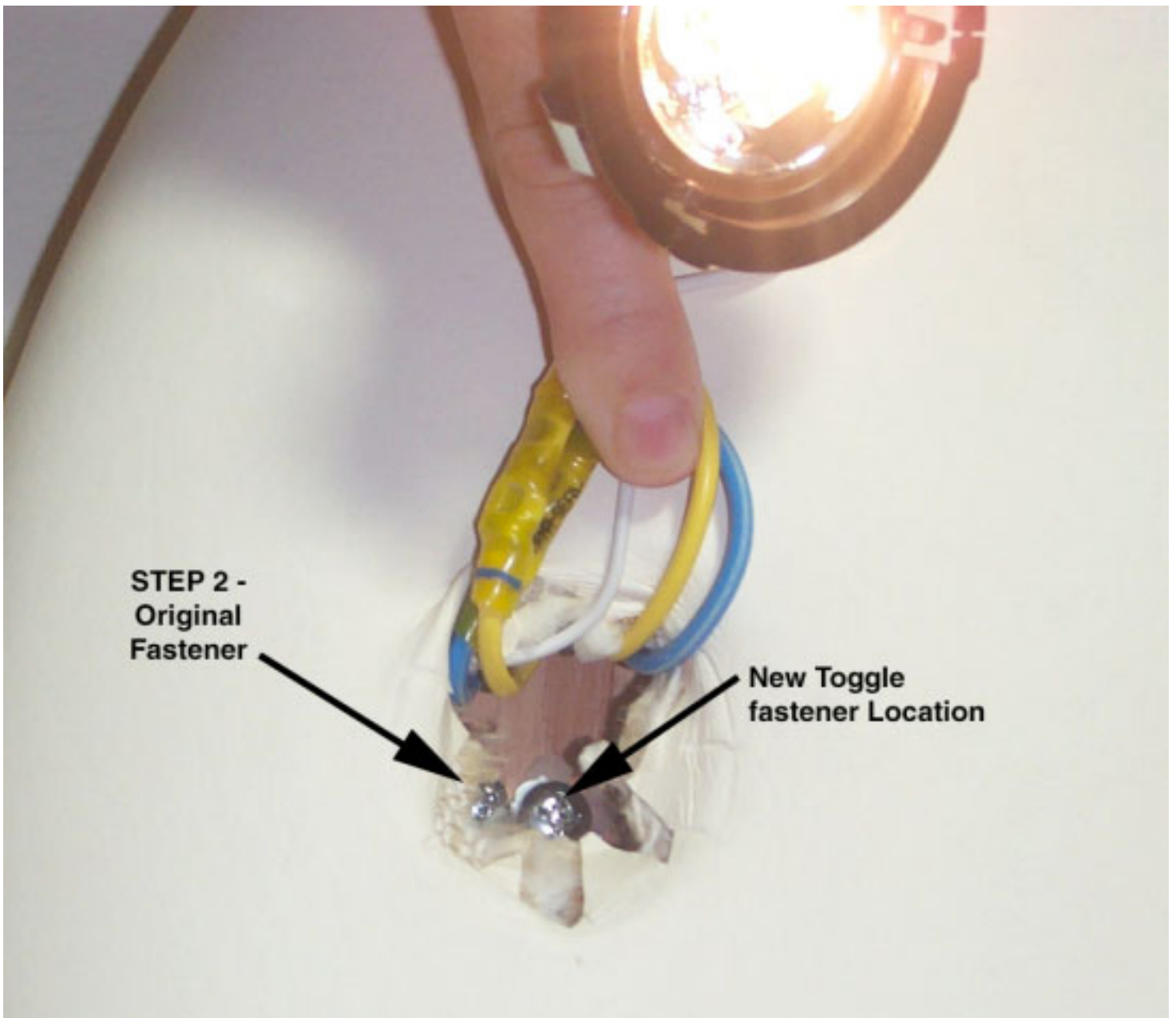

48 CONVERTIBLE

- fwd Headliner Accent Part – Reinforce fastening Procedure

Step 3

- Drill 1/2 " hole through
Both Parts
- Install Toggle Bolt-



Step 4

- Install -20 X 1 PH Bolt
<Repeat this in the Last 2 lites>